

Shown on model 203.0

- 1 Cap
- 2 Handle
- 3 Door lock cylinder
- 4 Bearing bracket
- 5 Screw of door lock
- 6 Left base
- 7 Right base
- 8 Screw for hinge strap

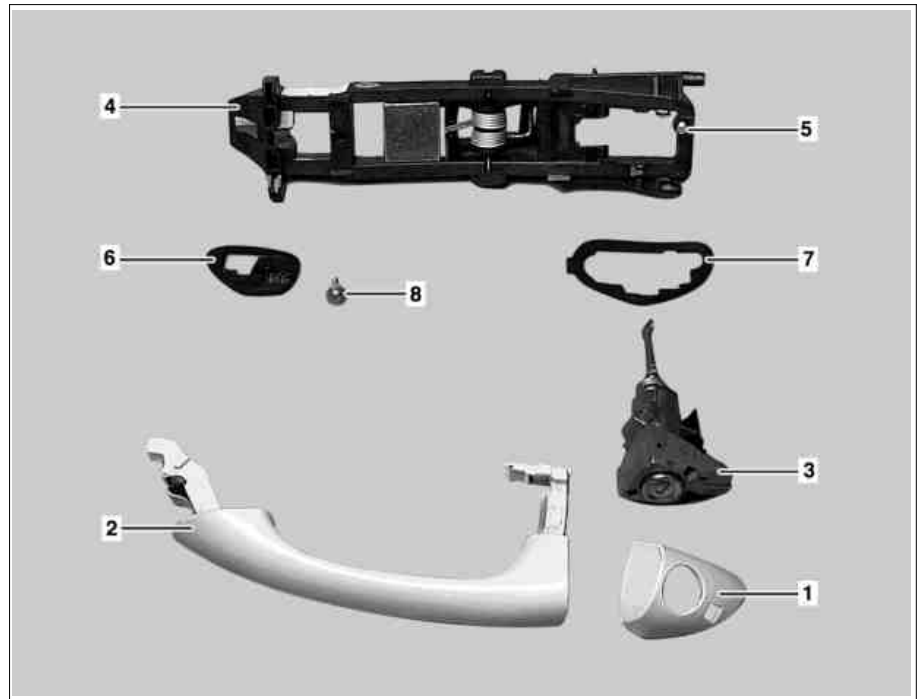

P72.10-2217-06

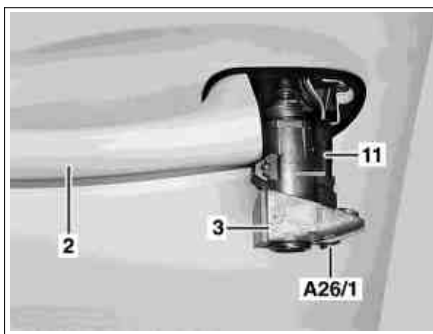

P72.10-2218-01

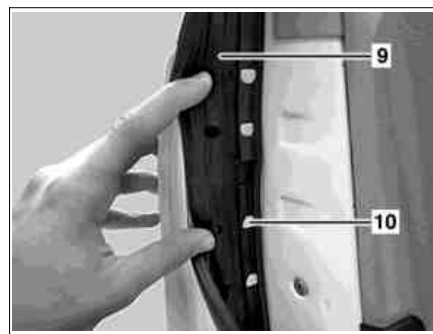

P72.10-2219-01

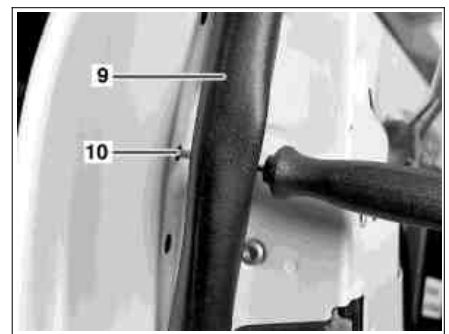



P72.10-2220-01

Illustrated on Model 203.0

- 2 Handle

- 3 Door lock cylinder
- 9 Door frame seal
- 10 Opening

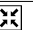
- 11 Clutch
- A26/1 Left front IR receiver

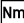
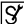
 	Remove/install		
1	Remove front door lining		AR72.10-P-1000P
2	Remove front door speakers	Model 203.7 With code (810) Sound system  Remove only left speaker.	AR82.62-P-7845P
3	Remove sidebag unit		AR91.60-P-0690P
4	Take off door foil		
5	Unclip door frame seal (9) in area of door lock		
6	Loosen bolt (5) in opening (10) and pull out door lock cylinder (3)		
7	Disconnect connector (11)		
8	Remove door lock cylinder (3)		
9	Pull handle (2) toward out of bearing bracket (4), remove		
10	Take off bases (6, 7)		
11	Remove screw (8)	 Bolt, door handle of front door  Torx bit set	*BA72.10-P-1005-01A *000589011000
12	Take out hinge strap (4) through access opening of door		
13	Install in the reverse order		
14	Carry out function check		

Nm Front door

Number	Designation	Model 203
BA72.10-P-1005-01A	Bolt, door handle of front door	Nm 3

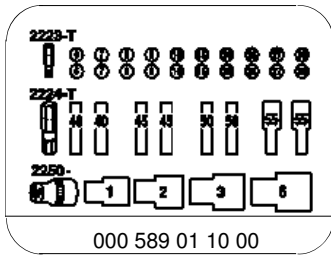

Torx bit set