

MODEL 203 (except 203.076 /276)

MODEL 209.3 /4

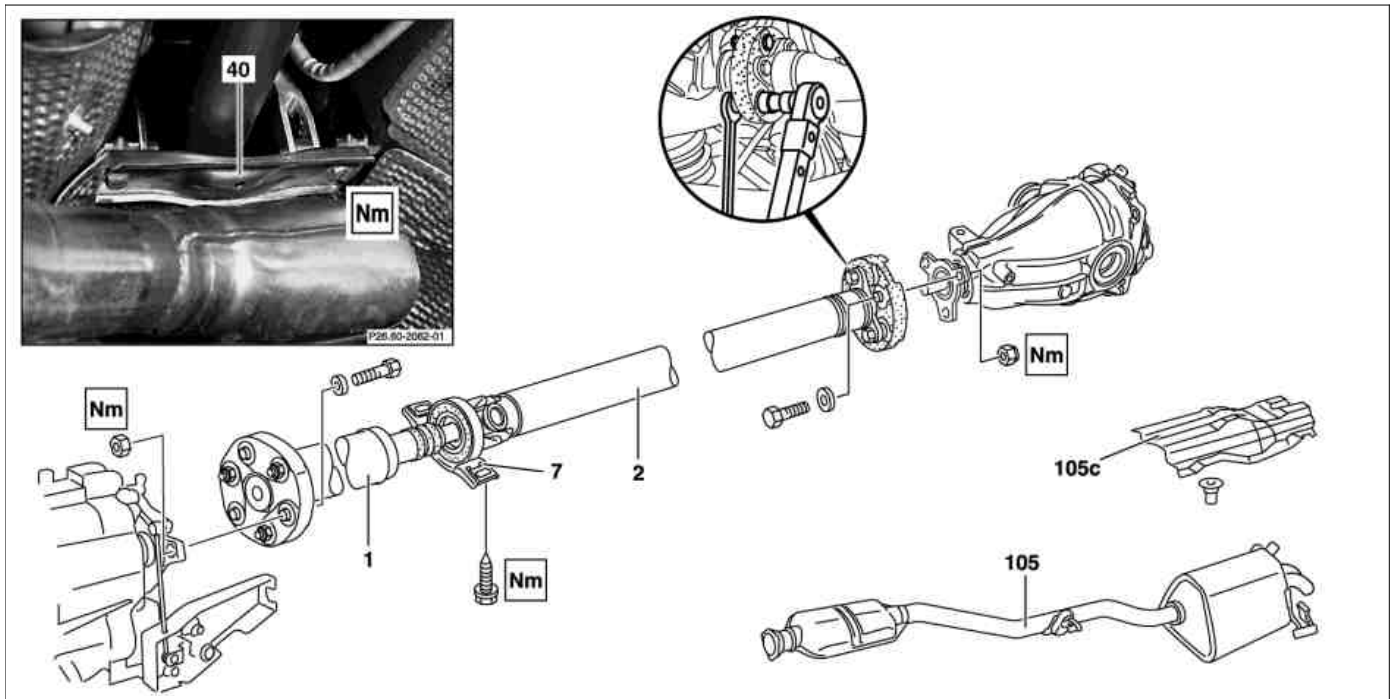

P41.10-2042-09

☒ ☒	Removing, Install		
ⓘ	Notes on self-locking nuts and bolts	All models	AH00.00-N-0001-01A
⚠ <b>Danger!</b>	<b>Risk of death</b> caused by vehicle slipping or toppling off of the lifting platform.	Align vehicle between columns of vehicle lift and position four support plates at vehicle lift support points specified by vehicle manufacturer.	AS00.00-Z-0010-01A
1	Raise vehicle		AR00.60-P-1000P
2	Remove exhaust system (105) from flange connection	Refer to: Exhaust system, removal and installation of complete system: Model 203.035/045/235/245/735/745/747 with engine 111. Model 203 with engine 112 Model 209 with engine 112 Model 209.375/475 with engine 113.968 Model 209.376 up to 23.4.04 Model 209.476/477 Model 209.376 as of 24.4.04 Model 209.377 Model 203, 209.3 with engine 271.942 Model 203.040/042/046/240/242/246/730/740/741/742/746 with engine 271 Model 209.341/342/441/442 with engine 271 Model 203.052/054/056/087/092/252/254/256/287/292/752/756 with engine 272 Model 209.354/356/454/456 with engine 272 Model 209.372/472 with engine 273 Model 203.018/218/718 with engine 612.990 Model 203, 209 with engine 646 Model 203.004/006/204/206/706 with engine 611.962 Model 203.016/216 with engine 612.962 Model 209.316 with engine 612.967 Model 203, 209 with engine 642	AR49.10-P-7000PR AR49.10-P-7000PV AR49.10-P-7000AC AR49.10-P-7000QD AR49.10-P-7000QK AR49.10-P-7000QB AR49.10-P-7000PF AR49.10-P-7000PM AR49.10-P-7000PP AR49.10-P-7000PI
3	Remove exhaust heat shield (105c)	<b>i</b> <b>Installation:</b> Replace sheet metal nuts if necessary.	
4	Remove rear engine crossmember and rear engine mount	Model 203 with 4MATIC	AR22.10-P-1160PW
5.1	Unscrew crossmember (40) at floor shift.	Model 203/209 with transmission 716.6 <b>Nm</b>	AR26.60-P-0600-01A *BA26.60-P-1003-01B

5.2	Detach front reinforcement bridge under the propeller shaft	Model 203, 209 with transmission 722.6 /9 Model 203 with 4MATIC: the exhaust shielding plate for the rear engine mount must not be detached from the reinforcement brace. 	<a href="#">*BA61.10-P-1006-01C</a>
6	Slacken bolts of propeller shaft intermediate bearing (7)		<a href="#">*BA41.40-P-1001-01A</a>
7	Disconnect front propeller shaft (1) from transmission	The flexible coupling remains on the propeller shaft. <b>Installation:</b> Attach propeller shaft to transmission.  	<a href="#">AR41.10-P-0050-02EA</a> <a href="#">AR41.10-P-0050-07EA</a> <a href="#">*BA41.10-P-1001-01A</a> <a href="#">*001589662100</a>
8	Detach rear propeller shaft (2) from rear differential assembly	Flexible disk remains on propeller shaft. <b>Installation:</b> Install propeller shaft on rear axle differential.  	<a href="#">AR41.10-P-0050-03EA</a> <a href="#">AR41.10-P-0050-04EA</a> <a href="#">*BA41.10-P-1002-01A</a> <a href="#">*001589662100</a>
9 <b>WF</b>	Loosen fitted sleeves on flexible coupling. Drift for loosening fitting sleeves in flex disks.		<a href="#">AR41.10-P-0050-09DA</a> <a href="#">WF58.50-P-4110-01A</a>
10	Remove bolts of propeller shaft intermediate bearing (7)	<b>Installation:</b> Mount propeller shaft center support bearing.	<a href="#">AR41.10-P-0050-11DA</a>
11	Detach front propeller shaft (1) from centering sleeve on transmission and rear propeller shaft (2) from centering sleeve on rear axle differential and remove to the rear	<b>Installation:</b> Pack insides of both centering sleeves with all-purpose grease. 	<a href="#">*BF41.10-P-1001-01A</a>
12 <b>BB</b>	Separate front driveshaft (1) and rear driveshaft (2) at the slide connection  Long-life grease (NLGI grade 2)	Only if required. <b>Installation:</b> Coat splined profile with Molykote grease: ↓ Connect sections of propeller shaft.	<a href="#">AR41.10-P-0050-05DA</a> <a href="#">BB00.40-P-0266-02A</a>
	<b>Checking</b>		
13	Check propeller shaft intermediate bearing (7) for wear.	Replace if necessary: ↓  Remove/install propeller shaft intermediate bearing and replacing deep-groove ball bearing.	<a href="#">AR41.10-P-0100P</a>
14	Check centering sleeves for wear	Replace if necessary: ↓ Replace centering sleeve.	<a href="#">AR41.10-P-0200P</a>
15	Check flexible coupling of front propeller shaft (1) for signs of wear	Replace if necessary: 	<a href="#">*BA41.10-P-1001-01A</a>
16	Check flexible coupling of rear propeller shaft (2) for signs of wear	Replace if necessary: 	<a href="#">*BA41.10-P-1002-01A</a>
17	Install in the reverse order		

**Shift mechanism**

Number	Designation	Transmission 716.6
BA26.60-P-1003-01B	Bolt, floor shift crossmember to frame floor	Nm 23

**Frame floor assembly**

Number	Designation	Model 203	Model 209 except 209.4	Model 209 .4

BA61.10-P-1006-01C	Collar bolt connecting front reinforcement brace to frame floor	Nm	23	23	23
--------------------	---	----	----	----	----

### Propeller shaft

Number	Designation			Model 203	Model 209
BA41.10-P-1001-01A	Self-locking nut, flexible coupling to transmission or front propeller shaft	M10	Nm	40	40
		M12	Nm	60	60
BA41.10-P-1002-01A	Self-locking nut, flexible coupling to rear propeller shaft or rear axle differential.	M10	Nm	40	36
		M12	Nm	60	58

### Propeller shaft intermediate bearing

Number	Designation			Model 203	Model 209
BA41.40-P-1001-01A	Bolt, propeller shaft intermediate bearing to frame floor assembly	Self-tapping screw	Nm	-	-
		Bolt with washer	Nm	-	-
		Bolt with collar and self-centering tip	Nm	30	30
		Bolt with collar and without self-centering tip	Nm	-	-

### Propeller shaft

Number	Designation			Model 203	Model 209
BF41.10-P-1001-01A	Grease quantity	Centering sleeve of propeller shaft	g	6	6
		Specifications for Operating Fluids	Sheet	BB00.40-P-0267-00A	BB00.40-P-0267-00A

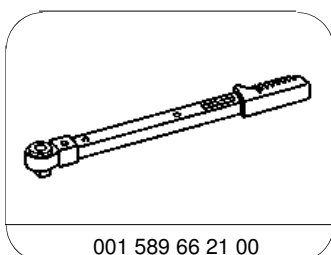

001 589 66 21 00

Torque wrench