

MODEL 203 (except 203.081 /084 /087 /092 /281 /284 /287 /292)

MODEL 209 except CODE (P98) Black Series

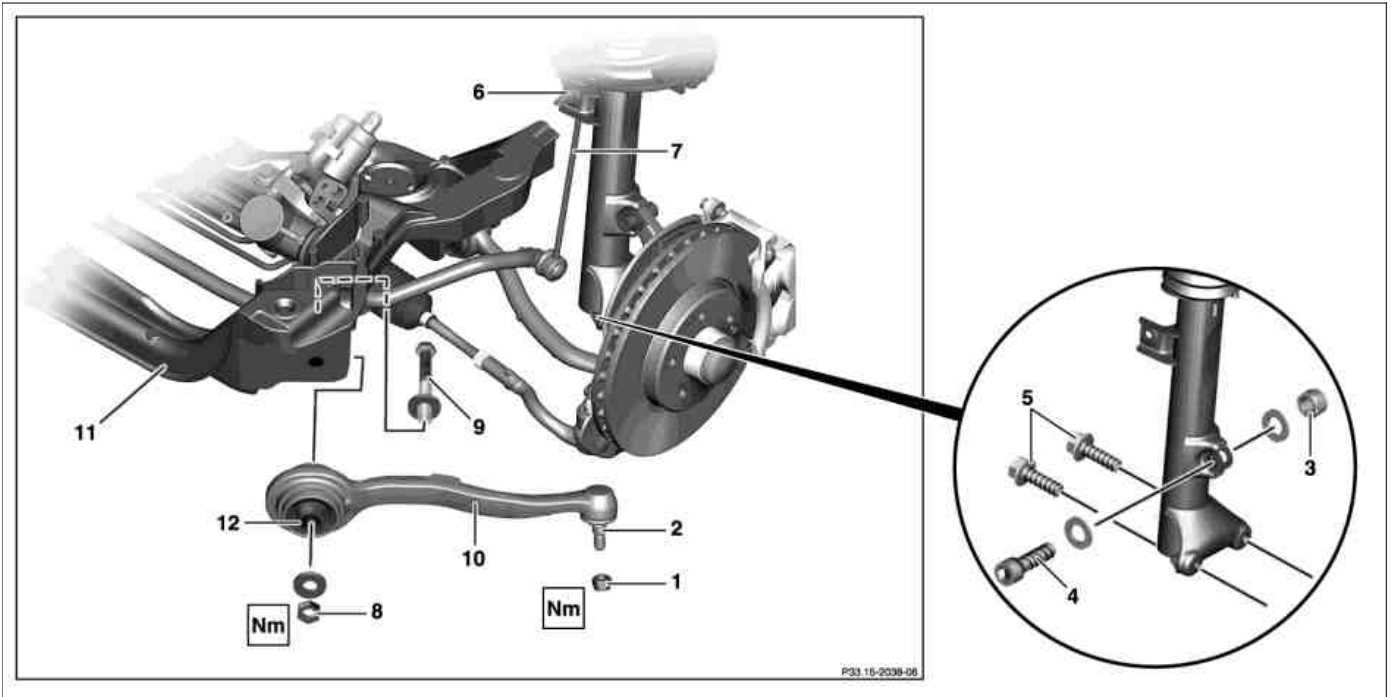

P33.15-2037-09

- 1 Nut
- 2 Ball head bolt
- 3 Nut, wheel carrier at the top
- 4 Screw
- 5 Bolts, wheel carrier at the bottom
- 6 Nut
- 7 Link rod
- 8 Nut
- 9 Screw
- 10 Torque strut
- 11 Front axle carrier
- 12 Rubber bushing
- 13 Bolts
- 14 Nuts

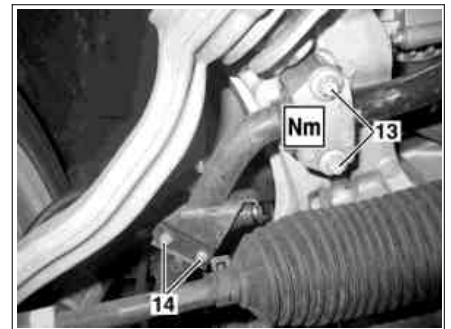

P32.20-2102-01

⚠	Remove/install		
⚠	Notes on self-locking nuts and bolts		AH00.00-N-0001-01A
⚠ Danger!	Risk of death caused by vehicle slipping or toppling off of the lifting platform.	Align vehicle between columns of vehicle lift and position four support plates at vehicle lift support points specified by vehicle manufacturer.	AS00.00-Z-0010-01A
1	Raise vehicle		AR00.60-P-1000P
2	Remove wheel.		AP40.10-P-4050Z
⚠ AP	Remove/install wheels, rotate if necessary		*BA33.20-P-1004-01E
3	Unscrew nut (1)	Nm	*171589003300
4	Press ball head bolt (2) out of the wheel carrier	☒ Puller	*171589003400
		☒ Thrust piece	
5	Unscrew nut of upper wheel carrier (3)		
6	Take out bolt (4)	Model 203 Nm Model 209 Nm	*BA32.25-P-1010-01B *BA32.25-P-1002-01E
7	Remove bolts from lower wheel carrier (5)	Model 203 Nm Model 209	*BA32.25-P-1008-01B

			*BA32.25-P-1003-01E
8	Unscrew nut (6)		*BA32.20-P-1004-02B
9	Remove link rod (7)		*BA32.20-P-1002-02B
10	Detach torsion bar on front axle carrier (11); to do this, unscrew bolts (13) on torsion bar	Right and left side 	*BA32.20-P-1009-02B
11	Remove headlamp range adjustment sensor. To do this, remove nuts (14)	Only on vehicles with code 614 Bi-xenon headlamp unit	
12	Unscrew nut (8)		*BA33.20-P-1007-01E
13	Remove bolt (9)		
14	Remove torque strut (10)	Pry out of front axle carrier (11) using assembly lever. Installation: Screw on nut (8) until it contacts the surface, but do not tighten it yet so that the rubber mount (12) of the torque strut (10) can turn when the vehicle is rocked to settle the suspension. Only tighten nut (8) in the ready-to-drive condition.	
	Checking		
15	Inspect radius rod (10) for visible signs of damage or deformation.		
16	Check rubber boots on rubber mount (12) for damage	The rubber boots should be retrofitted to protect the rubber mounts (12a). If necessary, replace or retrofit rubber boots: ↓ Remove/install rubber boots on rubber mount.	AR33.15-P-0160-03T
17	Check rubber mount (12)	If the rubber mount (12) is cracked or brittle, either the rubber mount (12) or the complete torque strut (10) has to be replaced to prevent a faulty chassis geometry from forming. On model 203 up to vehicle ident. end number A033999, F018699, R000999, the torque strut (10) has to be replaced if damage to the rubber mount (12) has been detected. On model 203 as of vehicle ident end number A034000, F018700, R001000 and on model 209 the rubber mount (12) can be replaced individually: ↓ Press out/press in rubber mount (12) of torque strut Extraction and insertion tool	AR33.15-P-0160-02P *220589064300
18	Install in the reverse order		

Front axle stabilizer bar

Number	Designation			Model 203 except model 203.020/220/08/09/28/29	Model 203.020/220
BA32.20-P-1002-02B	Self-locking nut of connecting rod to torsion bar	M10	Nm	60	55
		M10×1.5	Nm	-	-
		M12×1.5	Nm	-	-
		M14×1.5	Nm	-	-
BA32.20-P-1004-02B	Self-locking nut, connecting rod to spring strut	M10	Nm	60	-
		M10×1.5	Nm	-	-
		M12×1.5	Nm	-	-

		M12	Nm	-	80
BA32.20-P-1009-02B	Bolt, torsion bar retaining bracket to front axle carrier	Stage 1	Nm	40	30
		Stage 2	∠°	-	-

Nm Front axle stabilizer bar

Number	Designation			Model 209
BA32.20-P-1002-02B	Self-locking nut of connecting rod to torsion bar	M10	Nm	-
		M10×1.5	Nm	55
		M12×1.5	Nm	100
		M14×1.5	Nm	-
BA32.20-P-1004-02B	Self-locking nut, connecting rod to spring strut	M10	Nm	-
		M10×1.5	Nm	55
		M12×1.5	Nm	100
		M12	Nm	-
BA32.20-P-1009-02B	Bolt, torsion bar retaining bracket to front axle carrier	Stage 1	Nm	40
		Stage 2	∠°	-

Nm Front axle shock absorber

Number	Designation			Model 203 without 4MATIC
BA32.25-P-1008-01B	Self-locking bolt, suspension strut to steering knuckle at bottom		Nm	110
BA32.25-P-1010-01B	Self-locking nut, suspension strut to steering knuckle at top	Stage 1	Nm	100
		Stage 2	∠°	90

Nm Front axle shock absorber

Number	Designation			Model 209 without code P98
BA32.25-P-1002-01E	Self-locking nut, suspension strut to steering knuckle at top	Stage 1	Nm	100
		Stage 2	∠°	90

BA32.25-P-1003-01E	Self-locking bolt, suspension strut to steering knuckle at bottom	Nm	110
--------------------	---	----	-----

Nm Wheel location, hub

Number	Designation			Model 203	Model 209
BA33.20-P-1004-01E	Self-locking nut, radius rod to steering knuckle	Stage 1	Nm	50	50
		Stage 2	∠°	60	60
BA33.20-P-1007-01E	Self-locking nut, torque strut to front axle carrier	Stage 1	Nm	80	80
		Stage 2	∠°	120	120

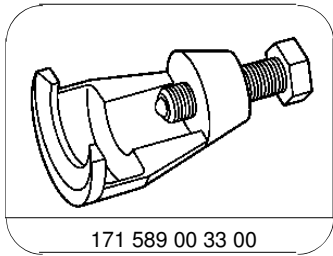

Puller

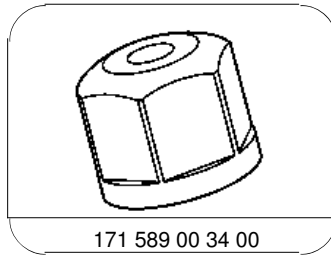

Thrust piece

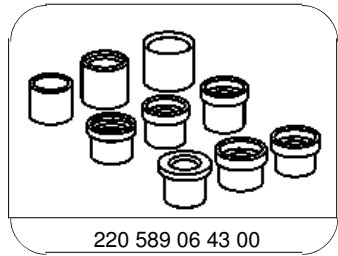

Press out/in tool