

TRANSMISSION 722.60 /61,  
722.620 ## as of 1681,  
722.621 ## as of 1977,  
722.622 ## as of 16287,  
722.623 /624 /625 /626 /627 /628 /629 /63 /66 /69

- 79 Wire cable/steering lock  
79a Adjusting button, wire cable/steering lock  
80 Wire cable/transmission  
80a Adjusting button, wire cable/transmission  
135 Brake pedal

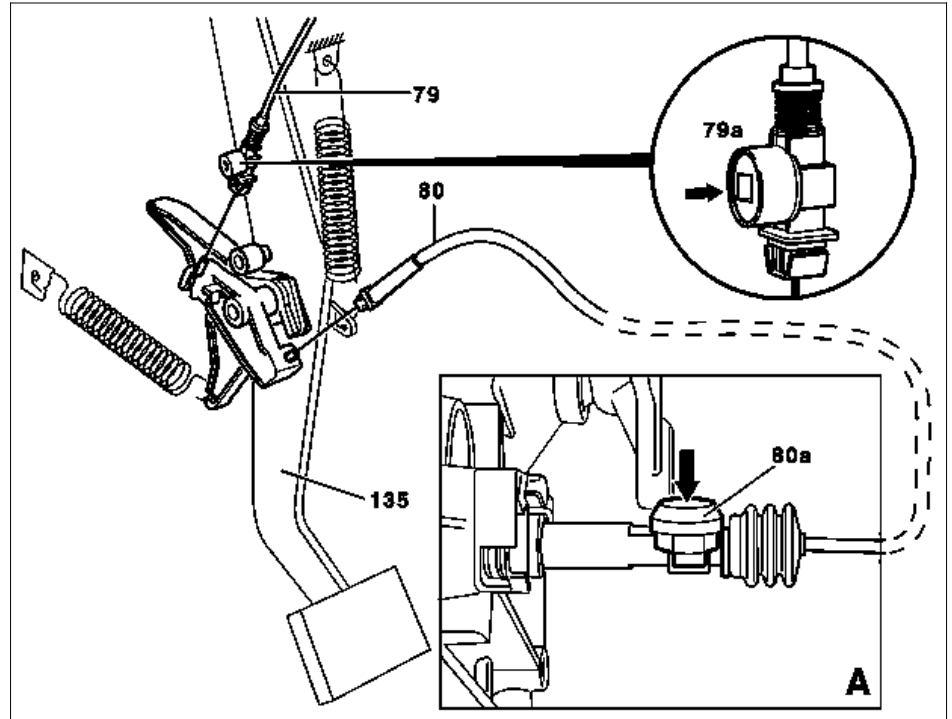

P27.60-0273-06

#### Modification notes

15.10.97	Sequence of work steps revised		
----------	--------------------------------	--	--

<b>i</b>	The selector lever must be in position "P" for all adjustment work.		
	<b>Adjusting wire cable/steering lock</b>	<b>i</b> The wire cable/transmission must be installed to adjust the wire cable/steering lock.	
1	Pretension spring on adjusting button (79a)		
2	Turn key in steering lock to position "0"		
3	Adjust wire cable/steering lock (79) by pressing adjusting button (79a) (arrow)		
	<b>Adjusting wire cable/transmission</b>		
4	Pretension spring on adjusting button (80a)		
5	Turn key in steering lock to position "0"		
6	Adjust wire cable/transmission (80) by pressing the adjusting button (80a) (arrow) <b>Figure A</b>		