

		<input checked="" type="checkbox"/> Puller <input checked="" type="checkbox"/> Clamping pliers <input checked="" type="checkbox"/> Clamping pliers	*001589503300 *140589013400 *201589003400
	Checking		
8	Check lateral and vertical runout of rear-axle shaft flange (10)	Permissible lateral runout Permissible radial runout If the test values are exceeded: ↓ replace rear-axle shaft flange.	*BE35.20-P-1001-01A *BE35.20-P-1002-01A
9	Install in the reverse order		

Test values for rear-axle halfshaft flange

Number	Designation	Model 129	Model 170	Model 171
BE35.20-P-1001-01A	Permitted lateral runout of rear-axle shaft flange when installed mm	0.03	0.03	0.03
BE35.20-P-1002-01A	Permitted vertical runout of rear-axle shaft flange at centering when removed mm	0.03	0.03	0.03

Test values for rear-axle halfshaft flange

Number	Designation	Model 202	Model 203	Model 208
BE35.20-P-1001-01A	Permitted lateral runout of rear-axle shaft flange when installed mm	0.03	0.03	0.03
BE35.20-P-1002-01A	Permitted vertical runout of rear-axle shaft flange at centering when removed mm	0.03	0.03	0.03

Test values for rear-axle halfshaft flange

Number	Designation	Model 209	Model 210
BE35.20-P-1001-01A	Permitted lateral runout of rear-axle shaft flange when installed mm	0.03	0.03
BE35.20-P-1002-01A	Permitted vertical runout of rear-axle shaft flange at centering when removed mm	0.03	0.03

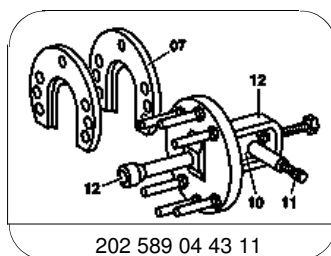

Pressure screw

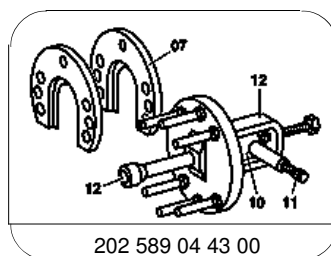

Extraction tool

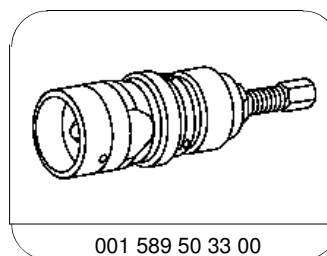

Puller

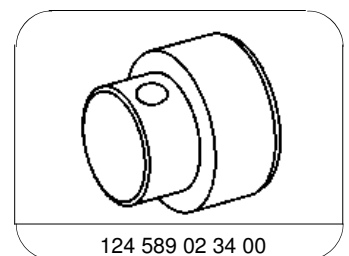

Thrust piece

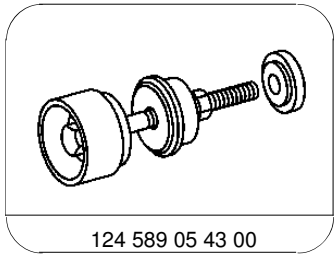

124 589 05 43 00

Extraction and insertion tool

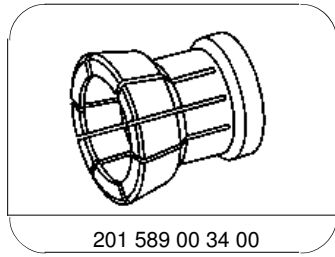

201 589 00 34 00

Chuck

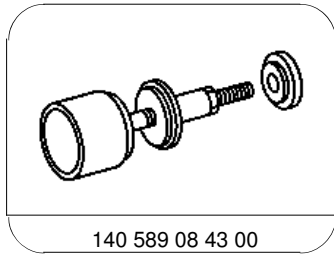

140 589 08 43 00

Extraction and insertion tool

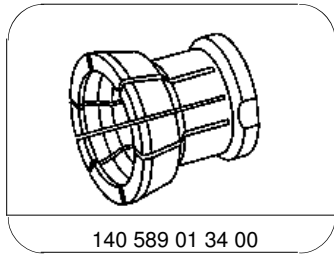

140 589 01 34 00

Chuck