

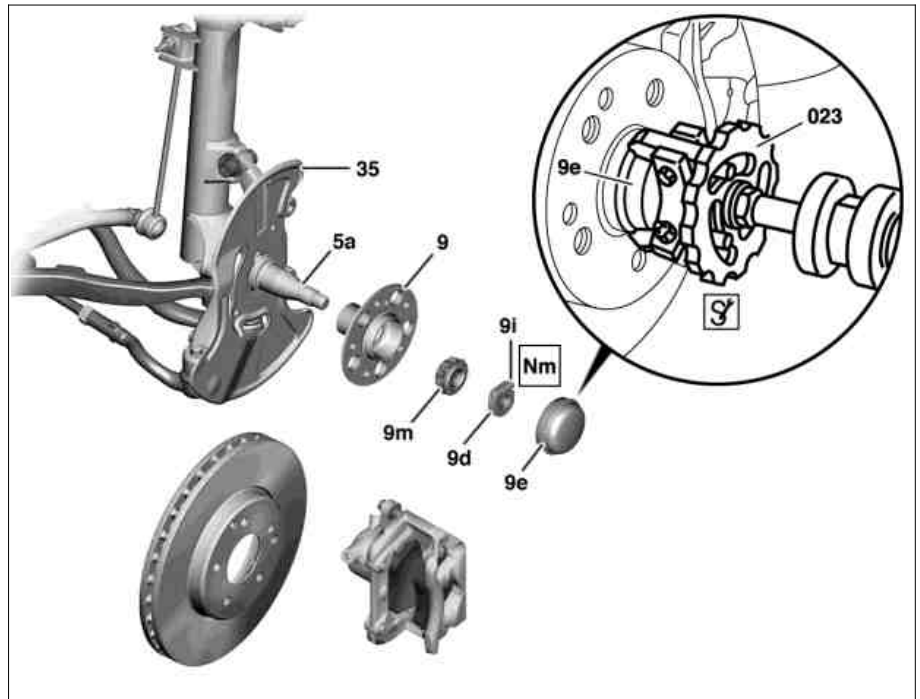

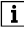

AR33.20-P-0310P	Remove/install front wheel hub	3.5.07
MODEL	203 (except 203.081 /084 /087 /092 /281 /284 /287 /292)	
MODEL	209	

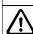

P33.20-2033-06

	<b>Remove/install</b>		
<b>Danger!</b>	<b>Risk of death</b> caused by vehicle slipping or toppling off of the lifting platform.	Align vehicle between columns of vehicle lift and position four support plates at vehicle lift support points specified by vehicle manufacturer.	AS00.00-Z-0010-01A
	Notes on self-locking nuts and bolts	All models	AH00.00-N-0001-01A
1	Raise vehicle		AR00.60-P-1000P
2 <b>AP</b>	Remove front wheel Remove/install wheels, rotate if necessary		AP40.10-P-4050Z
3	Remove brake disc	Model 203, 209.316/341/342/343/361/365/372/375/441/442/461/465/472/475 Model 209.376/476 up to 23.4.04 Model 209.376/476 as of 24.4.04 Model 209.377/477 Model 209.308/320/354/356/420/454/456	AR42.10-P-0220P  AR42.10-P-0220AC
4	Pull off hub cap (9e)		*116589223300
5	Remove outer tapered roller bearing (9m)	Undo hexagon socket head screw (9i), remove clamping nut (9d) and remove outer tapered roller bearing (9m). <b>Installation:</b> Adjust wheel bearing play. 	AR33.20-P-0300A *BA33.20-P-1001-01E
6	Pull off front wheel hub cover (9).	The pulse ring for the rpm recording is integrated in the radial sealing ring, therefore do not damage the radial sealing ring. <b>Installation:</b> Pack the front wheel hub (9) with grease and coat or pack radial sealing ring with grease as well as the space between the sealing lip and tapered roller bearings. Push the front wheel hub (9) with inner tapered roller bearing and radial sealing ring onto the steering knuckle spindle (5a).   	AR33.20-P-0310-01P  *201589103300 *001589503300 *201589033400
	<b>Check</b>		
7	Check brake cover plate (35)	Replace if necessary:	

8	Check kingpin (5a) for discoloration and wear on bearing seats or contact surface of radial sealing ring	 Discoloration can occur, for example, due to heat formation as a result of incorrectly adjusted bearing play. If necessary: ↓ Replace stub axle.	AR33.25-P-0400P
9	Check front wheel hub (9)	 Check threaded bores and pulse ring for damage.	
10	Inspecting tapered roller bearing and bearing races	Replace damaged bearings or bearing races: ↓ Disassemble/assemble front wheel hub (9).	AR33.20-P-0320P
11	Install in the reverse order		
 <b>Danger!</b>	<b>Risk of accident</b> when commissioning the vehicle due to a lack of braking effect when the service brake is operated for the first time after repair work	Before starting engine, actuate brake pedal several times until the pressure is built up and maintained in the brake system.	AS42.50-Z-0002-01A
12	Press the brake pedal several times until the brake pads contact the brake disks	 Firm resistance should be noticeable at the brake pedal.	

#### Wheel location, hub

Number	Designation		Model 203	Model 209
BA33.20-P-1001-01E	Screw for clamp nut to adjust front wheel bearing end float	Nm	11	11

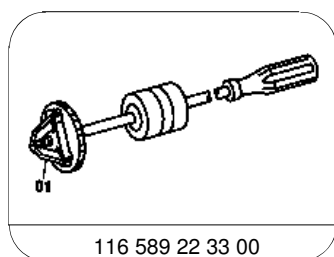

Removal and installation tool

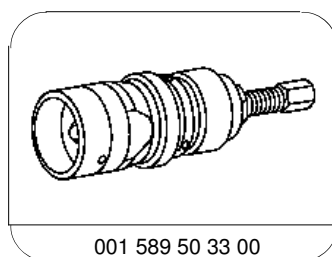

Puller

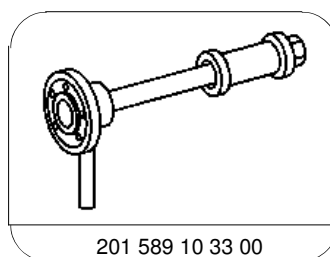

Impact extractor

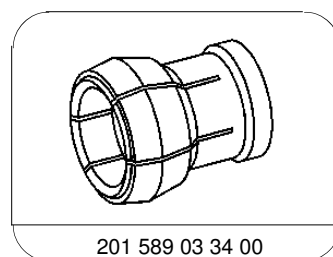

Chuck