

MODEL 230.4

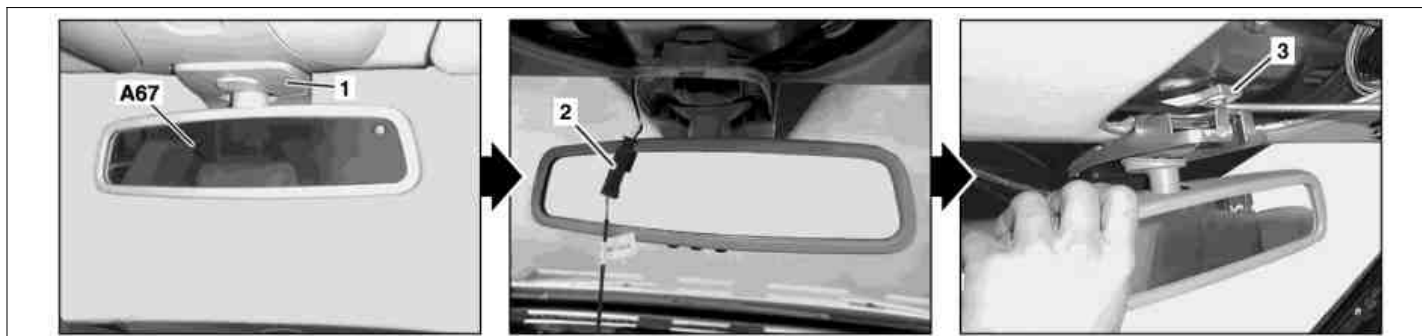

P68.40-2045-07

- 1 Cover
 2 Electrical connector (with code (386) Preinstallation for cell phone telephone, UPCI system or code (388) Cell phone telephone, UPCI system)
 3 Retaining plate
 A67 Inside rearview mirror unit

☒ ☒	Remove/install		
⚠ Danger!	Risk of injury Skin, eye and respiratory system irritation may occur through contact or inhalation of substances contained in the mirror lens	Wear protective gloves and safety glasses.	AS60.00-Z-0008-01R
ⓘ	Information on preventing damage to electronic components due to electrostatic discharge		AH54.00-P-0001-01A
1	Remove overhead control panel control unit		AR82.20-P-1000R
2	Unclip covering (1)		
3	Disconnect electrical connector (2)	On vehicles with code (386) Preinstallation for cell phone telephone, UPCI system or code (388) Cell phone telephone, UPCI system	
4	Remove cover (1)		
5	Pry off inside rearview mirror unit (A67) of retaining plate (3) with suitable prying tool.	ⓘ Insert prying tool between inside rearview mirror unit (A67) and retaining plate (3).	
6	Remove inside rearview mirror unit (A67)		
7	Install in the reverse order		
8	Program garage door opener transmitter unit ⓘ Notes on programming garage door opener transmitter unit	Only when replacing inside rearview mirror (A67) on vehicles with code (231) Garage door opener or code (232) Garage door opener with frequency 284-390 MHz.	AH68.05-P-0002-01A