

ENGINE 111

- 3 Tensioning pulley
 6 Tensioning pulley collar nut
 7 End cover (up to 03. 93)
 13 Bolt+washer M8×35
 14 Bolt+washer M8×25
 15 Hexagon socket wrench waf 10

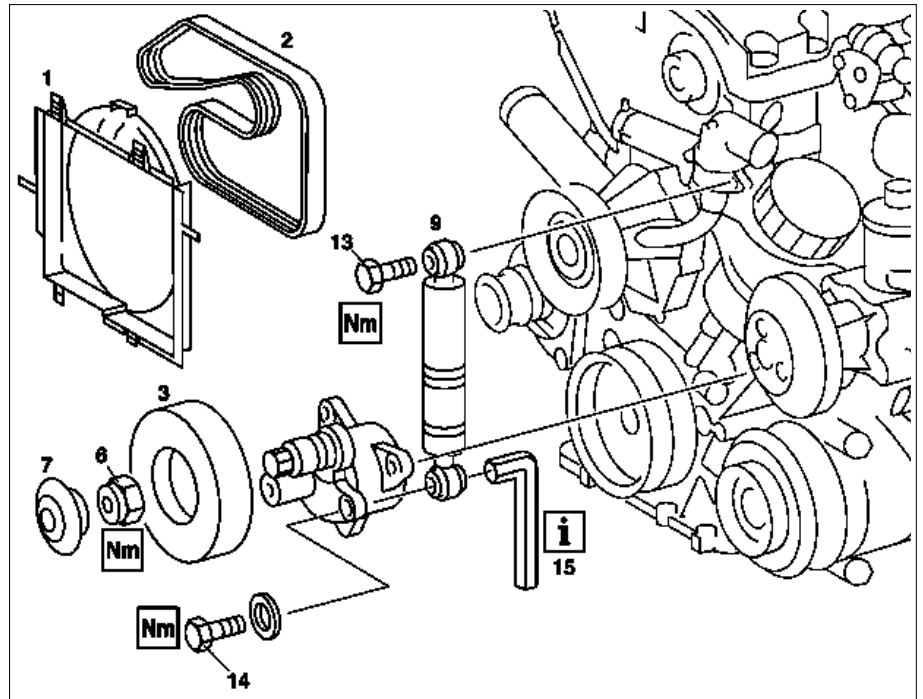

P13.22-0215-06

	Removal, installation		
1	Remove fan shroud (1)		Models with fan shroud AR20.40-P-6800HA
2	Remove poly V-belt (2)		AR13.22-P-1202A
3	Unbolt tensioning pulley (3), pull off	Nm	*BA13.25-P-1002-01B
4	Unbolt shock absorber of poly V-belt tensioning device (9)	Nm i Use a suitable tool (15), eg. appropriately ground hexagon wrench waf10, to counter-hold from the rear at the bottom boss	*BA13.25-P-1003-01B
5	Install in the reverse order		

Nm Belt tensioning device

Number	Designation		Engine 111
BA13.25-P-1002-01B	Collar nut of belt tensioning pulley to belt tensioner	Nm	25
BA13.25-P-1003-01B	Bolts of shock absorber of tensioning device	Nm	25