

MODEL 170, 202, 208

Figures shown model 202

22b Torsion bar mounting bar
 22c Nut
 044 Puller
 044a Thrust piece

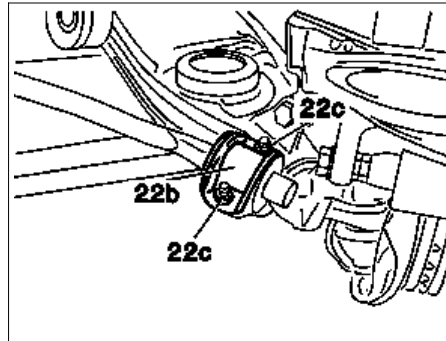

P33.20-0275-01

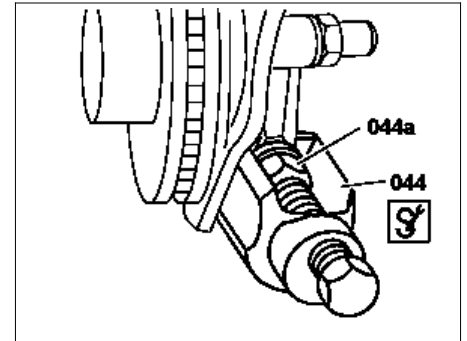

P33.20-0283-01

11 Shock absorber
 11k Screw
 Nut
 19 Transverse control arm bolt
 19a Washer
 19b Nut
 20 Transverse control arm bolt
 20a Washer
 20b Nut

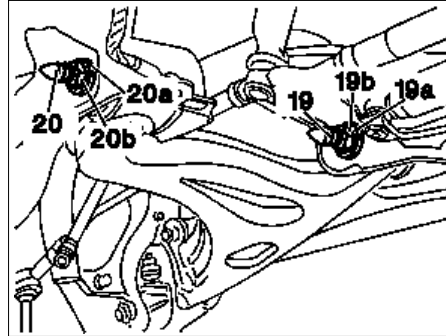

P33.20-0272-01

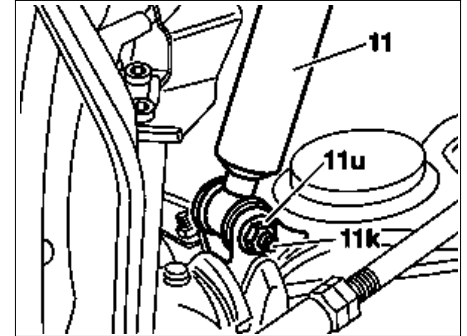

P33.20-0268-01

	Remove/install		
1	Remove front wheel		AP40.10-P-4050Z
2	Remove front springs		AR32.20-P-0200B
3	Detach torsion bar mounting bar (22b)		*BA32.20-P-1001-02C
4	Unscrew nut from supporting joint		*BA33.20-P-1004-01A
5	Screw thrust piece (044a) onto the ball stud of the supporting joint		*140589006300
6	Press supporting joint out of steering knuckle using puller (044)	 	*202589023300
7	Detach damper (11) from transverse control arm		*BA32.25-P-1003-01B
8	Detach lower control arm from frame floor assembly	Model 170: Detach lower engine compartment paneling Installation: Tighten nuts in ready-to-drive condition. Installation: Install repair bolts. If repair bolts have already been installed, observe installation position and install bolts in the same position again. Observe technical modifications ↓ Bearing bracket of lower control arm	AR33.10-P-0200-01B AR40.20-P-0322-01B *BA33.20-P-1009-01A
			BT33.20-P-9308-01B
9	Unscrew nut of supporting joint to transverse control arm		*BA33.20-P-1006-01A
10	Screw thrust piece onto the ball pivot of the supporting joint		*140589006300
11	Using puller, press supporting joint out of lower control arm	 	*202589023300
12	Check transverse control arm for bending and corrosion		
13	Install in the reverse order		
14	Perform a wheel alignment check		AR40.20-P-0200A

Nm Front axle stabilizer bar

Number	Designation		Model 202	Model 208
BA32.20-P-1001-02C	Self-locking nut for attaching retaining bracket to transverse control arm	Nm	20	20

Nm Front axle stabilizer bar

Number	Designation		Model 170
BA32.20-P-1001-02C	Self-locking nut for attaching retaining bracket to transverse control arm	Nm	20

Nm Front axle shock absorber

Number	Designation		Model 170	Model 202	Model 208
BA32.25-P-1003-01B	Self-locking nut, shock absorber to wishbone	Nm	55	55	55
		Yellow Nm	-	-	-
		silver/blue Nm	-	-	-

Nm Wheel location, hub

Number	Designation		Model 170	Model 202	Model 208
BA33.20-P-1004-01A	Self-locking nut, supporting joint to steering knuckle	Nm	105	105	105
BA33.20-P-1006-01A	Self-locking nut, supporting joint to lower transverse control arm	Nm	105	105	105
BA33.20-P-1009-01A	Self-locking nut, lower wishbone to frame	Nm	120	120	120

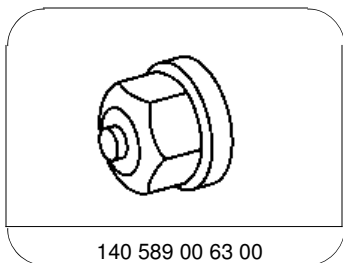

140 589 00 63 00

Thrust piece

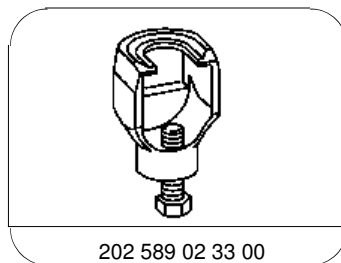

202 589 02 33 00

Puller