

MODEL 209 except CODE (P98) Black Series

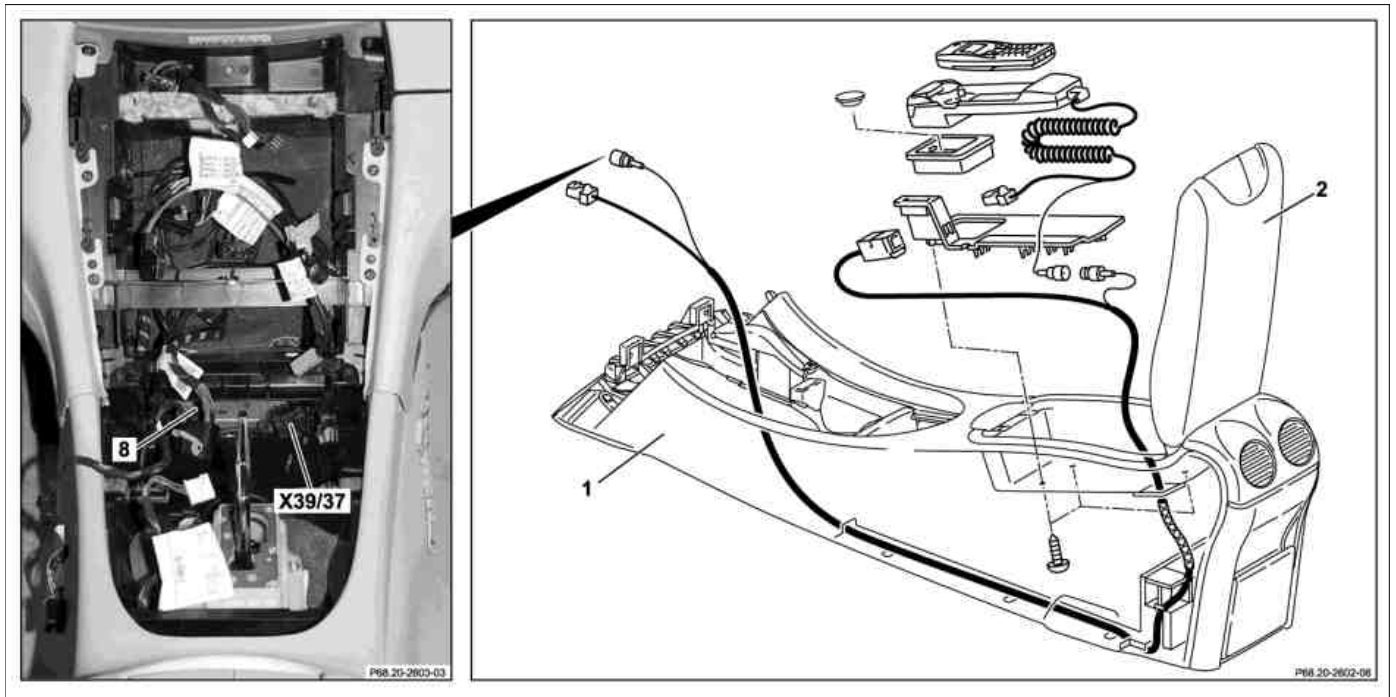

P68.20-2601-09

Shown on vehicle with code 854 MB cell phone

- 1 Center console
- 2 Center arm rest

- 8 Antenna line connector (with code 853 MB standard telephone or with code 854 MB cell phone)

- X39/37 Cell phone separation point (with code 853 MB standard telephone or with code 854 MB cell phone)

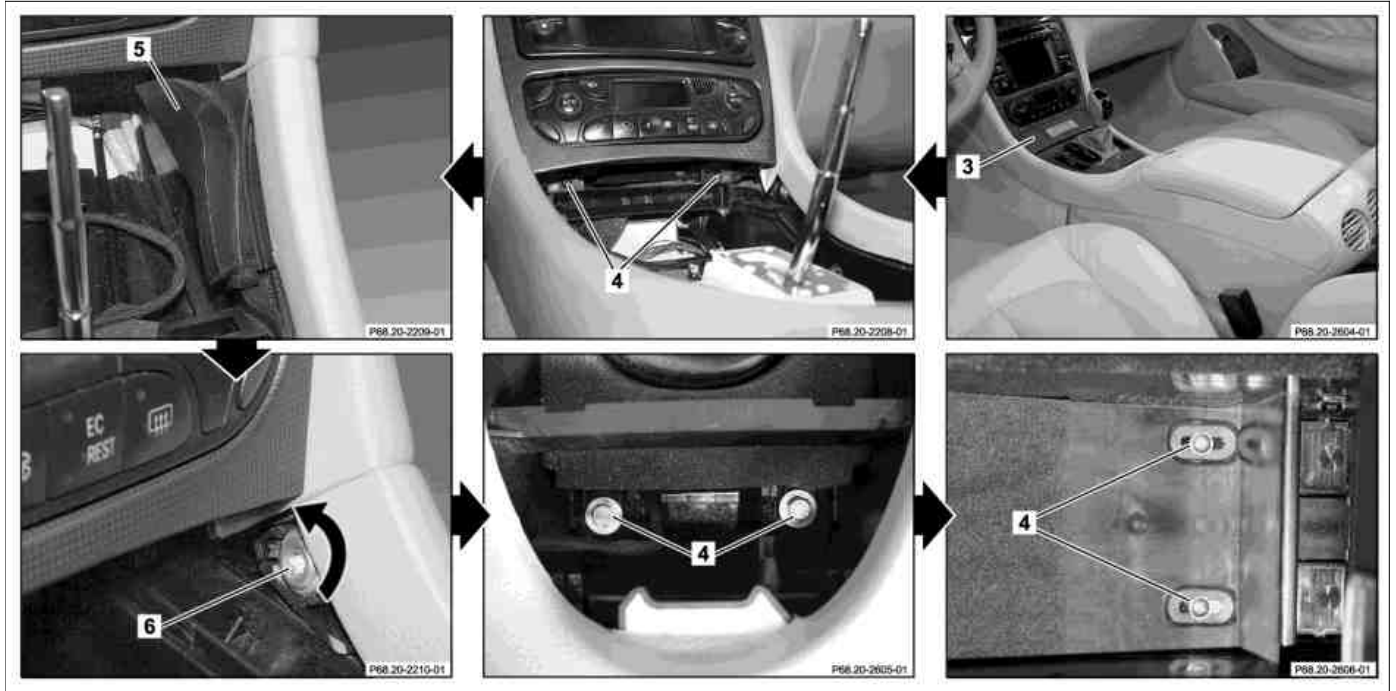

P68.20-2600-09

- 3 Ashtray housing
- 4 Bolts

- 5 Side cover

- 6 Arresting pin bolt

☒ ☒	Remove/install		
1	Remove ashtray housing (3) at front on center console (1)	<b>i</b> <b>Installation:</b> Check ashtray housing mechanism (3) for proper function, if necessary loosen threaded connection of center console (1) and tighten center console (1) without tension..	AR68.20-P-2400P
2	Move center armrest (2) to vertical position.		

3	Remove carpet insert in stowage compartment.		
4	Remove bolts (4)	<b>i</b> <b>Installation:</b> Ensure that center console (1) is installed without tension.	
5	Unclip side covers (5) in installation shaft of ashtray housing (3)		
6	Turn bolt for arresting pin (6) on left and right side approx. one half turn (arrow)		
7	Disconnect electrical cell phone separation point (X39/37)	Only on vehicles with code 853 MB standard telephone or with code 854 MB cell phone.	
8	Disconnect antenna line connector (8)	Only on vehicles with code 853 MB standard telephone or with code 854 MB cell phone.	
9	Lift center console (1) in rear area and remove		
10	Reinstall in opposite order		