

MODEL 209

Shown on driver door

- 1 Cap
- 2 Door handle
- 3 Guide
- 4 Washer
- 5 Washer
- 6 Screw of door lock

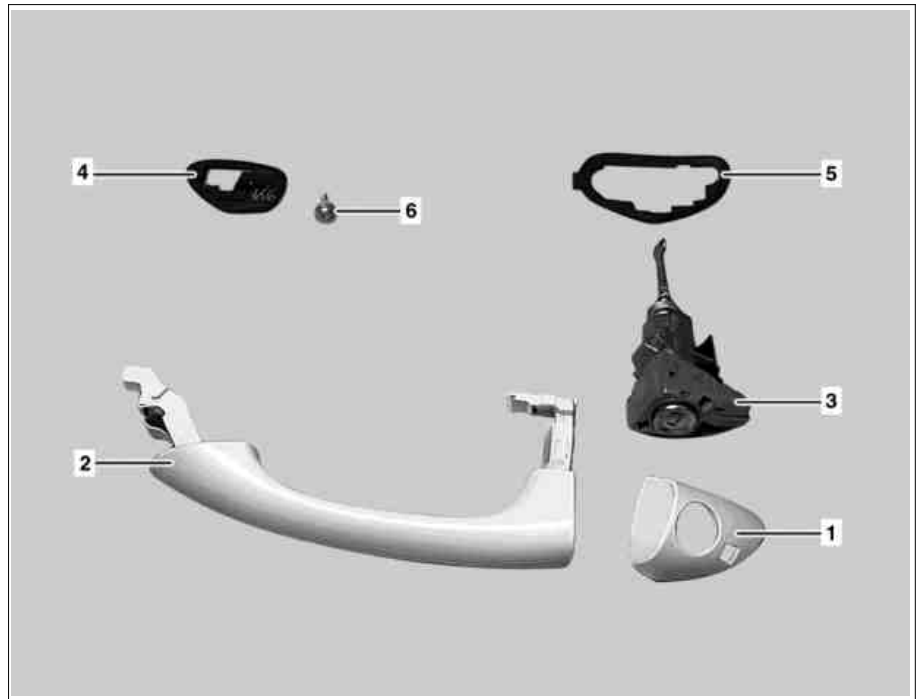

P72.10-2429-06



P72.10-2433-07

Shown on driver door

- 2 Door handle
- 3 Guide
- 7 Door frame seal
- 8 Opening
- 9 Electrical connector
- A26/1 Left front IR receiver
- A26/2 Right front IR receiver (only <sup>Ⓝ</sup> and <sup>(USA)</sup> up to 31.5.04)

Modification notes

4.2.04	"Disconnect/connect battery ground line" removed		
--------	--	--	--

	Remove/install		
1	Unclip door frame seal (7) in area of door lock		*110589035900
2	Unscrew bolt from door lock (6)	Accessible through opening (8) 	*BA72.10-P-1005-01A
3	Pull out guide (3)		
4	Disconnect electrical connector (9)		
5	Remove guide (3) with cap (1)		
6	Remove door handle (2)	Pull out of hinge strap toward rear.	
7	Take off bases (4, 5)		
8	Install in the reverse order		
9	Carry out function check		

Front door

Number	Designation	Model 209
--------	-------------	-----------

BA72.10-P-1005-01A	Bolt, door handle of front door	Nm	2

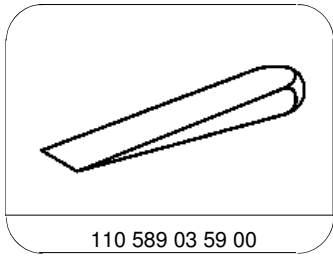

Mounting wedge