

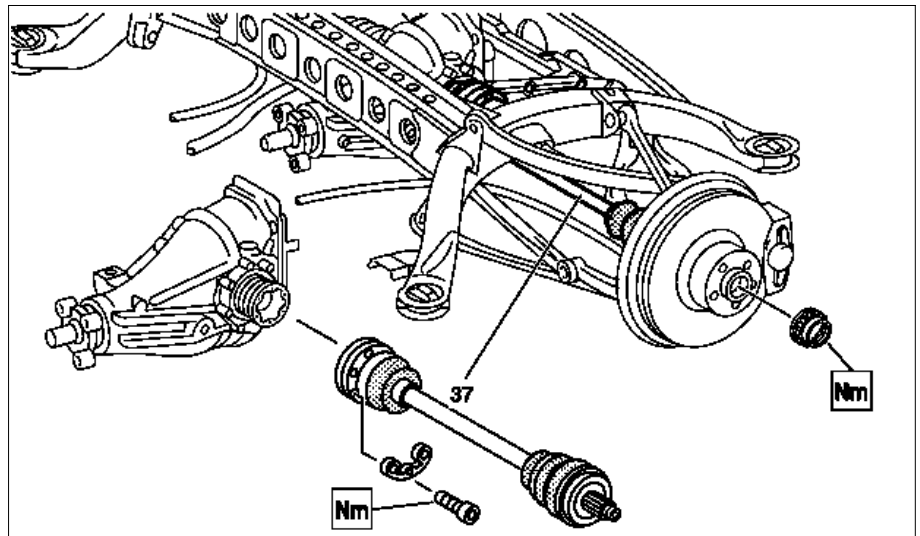

MODEL 203, 209  
bolted rear axle shaft

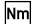

P35.30-0207-05

☒ ☒	Remove/install		
⚠ <b>Danger!</b>	<b>Risk of death</b> caused by vehicle slipping or toppling off of the lifting platform.	Align vehicle between columns of vehicle lift and position four support plates at vehicle lift support points specified by vehicle manufacturer.	AS00.00-Z-0010-01A
1	Remove exhaust system at flange connection	Engine 111.951 in model 203.035/ 235/ 735, Engine 111.955 in model 203.045/ 245/ 745, Engine 111.981 in model 203.747 Engine 112 in model 203, 209, Engine 113.968 in model 209.375 /475, Engine 113.987 in model 209.376 up to 23.4.04, Engine 113.987 in model 209.476, Engine 156.982 in model 209.477 Engine 611.962 in model 203.004 /006 /204 /206 /706, Engine 612.962 in model 203.016 /216, Engine 612.967 in model 209.316 Engine 612.990 in model 203.018 /218 /718 Engine 646 in model 203, 209 Engine 113.987 in model 209.376 as of 24.4.04, Engine 156.982 in model 209.377 Engine 271.940 in model 203.042/ 242/ 742, Engine 271.940 in model 209.342 /442, Engine 271.946 in model 203.046/ 246/ 746, Engine 271.948 in model 203.040/ 240/ 740, Engine 271.921 in model 203.730, engine 271.955 in model 203.741, Engine 271.955 in model 209.341 /441 Engine 271.942 in model 203, 209.3 Engine 272 in model 203.052 /054 /056 /087 /092 /252 /254 /256 /287 /292 /752 /756, Engine 272 in model 209.354 /356 /454 /456, Engine 273 in model 209.372 /472 Model 203, 209 with engine 642	AR49.10-P-7000PR  AR49.10-P-7000PV  AR49.10-P-7000PP  AR49.10-P-7000PF AR49.10-P-7000PM AR49.10-P-7000AC  AR49.10-P-7000QK  AR49.10-P-7000QD AR49.10-P-7000QB  AR49.10-P-7000PI
2	Detach twelve-point nut on rear axle (37)	<b>i</b> <b>Installation:</b> Replace twelve-point collar nut. 	AR35.30-P-0115-01A  *BA35.30-P-1001-01A
3 	Remove rear wheel Remove/install wheels		AP40.10-P-4050Z
4	Detach rear axle shaft (37) from connecting flange	 In order to prevent wheel bearing damage, the vehicle must not be moved on the wheels when the rear axle shaft (37) is removed.	

		<p><b>i</b> Move rear axle (37) shaft to approximately horizontal position, push together and remove diagonally downwards from connecting flange.</p> <p><b>i</b> Ensure that when loosening the bolts the tool insert is properly inserted in the polygon head or hexagon socket profile. Clean the polygon head profile or hexagon socket profile if necessary.</p> <p><b>i</b> <b>Installation:</b> Replace self-locking polygon head bolts, hexagon socket bolts or torx bolts and washers. Oil thread and bolt head contact surface lightly.</p> <p><b>Nm</b></p>	*BA35.30-P-1002-01A
5	Press rear axle shaft (37) out of the rear axle shaft flange	<p><b>i</b> Do not damage rotor for rpm sensor and boot on the rear axle shaft (37). If the rear axle shaft (37) is difficult to remove:</p> <p style="text-align: center;">↓</p> <p>Pressing rear axle shaft (37) out of the rear axle shaft flange.</p> <p><b>i</b></p> <p><b>i</b></p>	<p>AR35.30-P-0115-03BF</p> <p>*210589034300</p> <p>*210589014000</p>
<b>&lt;</b>	<b>Checking</b>		
6	Check constant velocity joints, boots and end cover for leaks and damage	<p><b>i</b> If the outer constant velocity joint is defective, the rear axle shaft (37) must be replaced complete.</p> <p><b>i</b> If the inner constant velocity joint is defective, the boots are damaged or leaking or the end cover is damaged, replace the appropriate parts:</p>	AR35.30-P-0660P
7	Install in the reverse order		

**Nm** Rear axle shaft

Number	Designation		Model 203	Model 209 except 209.377/477, model 209 without code P98	Model 209.377/477, model 209 with code P98	
BA35.30-P-1001-01A	Collar nut, rear axle shaft to rear axle shaft flange	Stage 1	Nm	220	220	320
		Stage 2	°	-	-	-
BA35.30-P-1002-01A	Self-locking bolt, rear axle shaft to connecting flange (thread and bolt head contact surface oiled)	M10	Nm	70	-	-
		M12	Nm	-	-	-

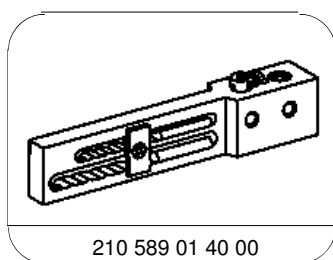

210 589 01 40 00

Bracket

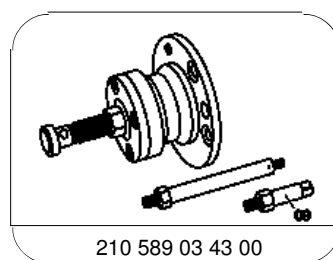

210 589 03 43 00

Extraction and insertion tool