

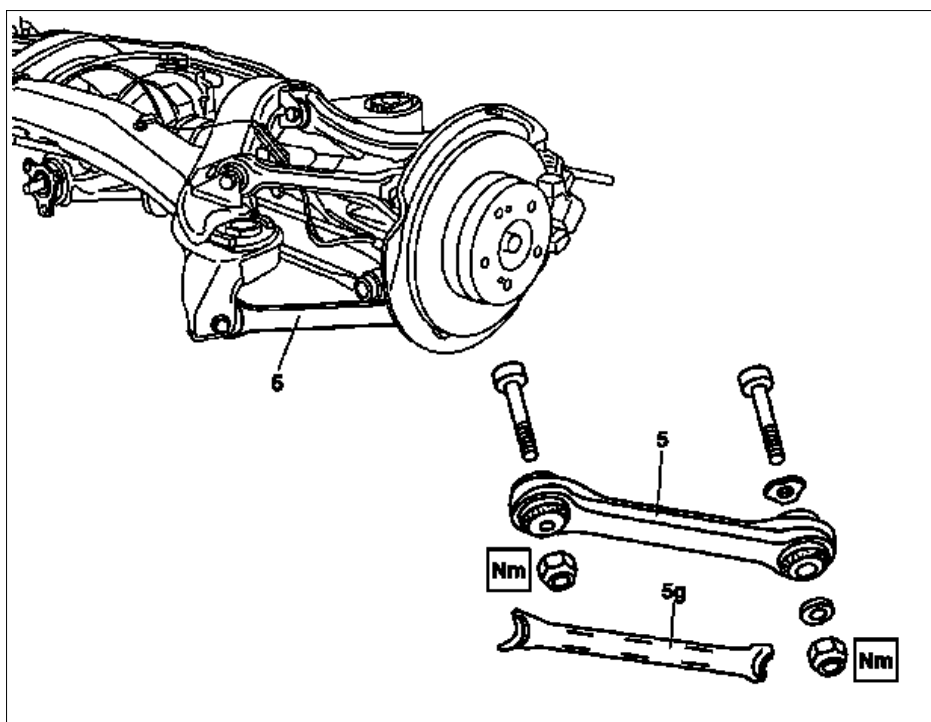







MODEL 203, 209

- 5 Thrust arm
5g Thrust arm cover

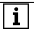

P35.20-2052-06

	Remove/install		
 Danger!	Risk of death caused by vehicle slipping or toppling off the lifting platform.	Align vehicle between columns of vehicle lift and position four support plates at vehicle lift support points specified by vehicle manufacturer.	AS00.00-Z-0010-01A
	Notes on self-locking nuts and bolts		AH00.00-N-0001-01A
	While working on the rear axle care must be taken to ensure that the surface of all aluminum components do not get any scratches, cracks and notches. Otherwise the service life of the parts will be affected		
 Installation	Only tighten nuts and bolts of chassis components when vehicle is in a ready-to-drive condition.		
1	Secure vehicle on the lifting platform		
2	 Remove rear wheel Remove/install wheels		AP40.10-P-4050Z
3	Raise wheel carrier using transmission jack and transmission platform until rear axle shaft is roughly horizontal		
4	Detach thrust arm (5) from wheel carrier	 Installation: The rear axle shaft must be approximately horizontal when tightening the bolted connection in order not to not destroy the rubber mounts. Nm	*BA35.20-P-1002-05A
5	Detach thrust arm cover (5g)	Vehicles without code P98 Black Series  Observe correct installation position.	
6	Detach thrust arm (5) from rear axle carrier and remove	 Installation: The rear axle shaft must be approximately horizontal when tightening the bolted connection in order not to not destroy the rubber mounts. Nm	*BA35.20-P-1001-05A
7	Install in the reverse order		

Number	Designation		Model 203	Model 209
BA35.20-P-1001-05A	Self-locking nut, torque strut to rear axle carrier	Nm	70	50
		Δ°	-	45
BA35.20-P-1002-05A	Self-locking nut, thrust arm to wheel carrier	M10 Nm	-	-
		M12 Nm	70	50
		Δ°	-	45