

MODEL 203

MODEL 209 except CODE (P98) Black Series

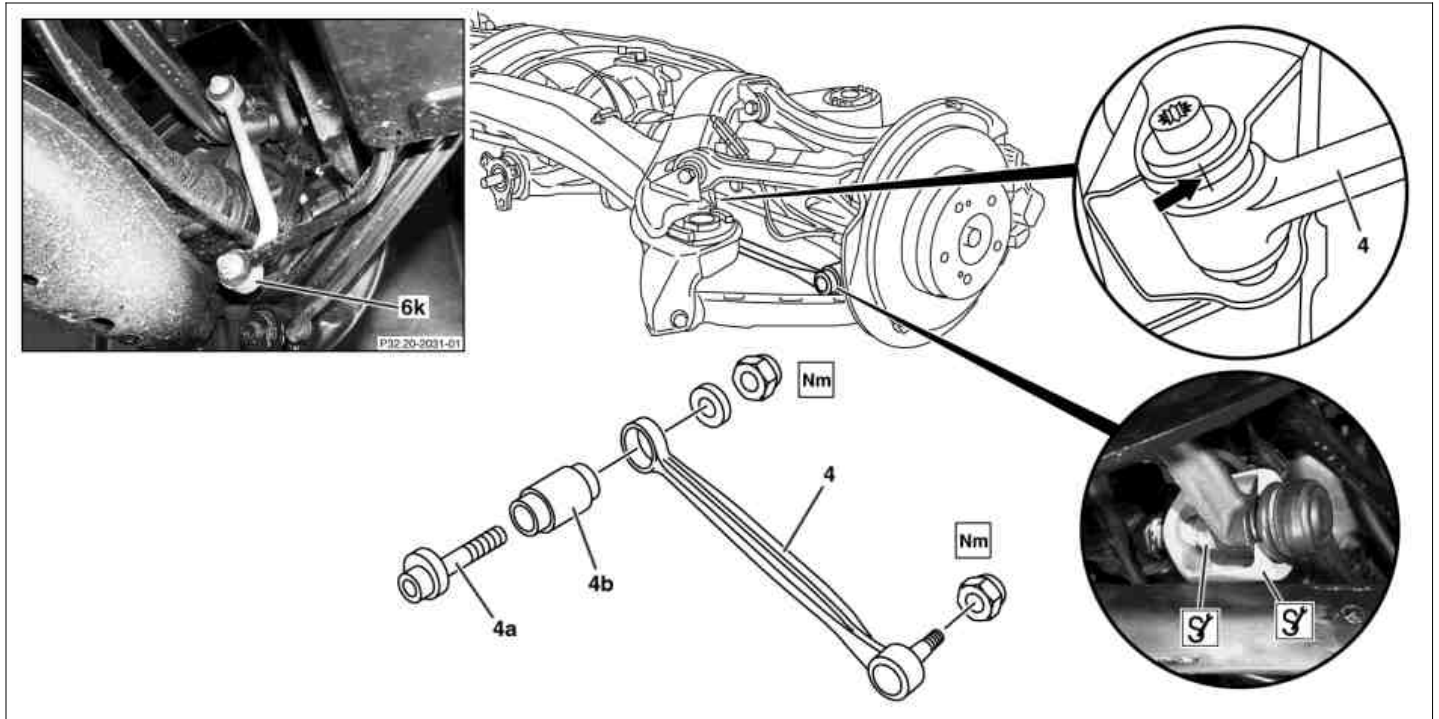

P35.20-2059-09

4 Tie rod
4a Screw

4b Rubber bushing

6k Link rod

Modification notes

3.5.07	Self-locking nut, tie rod to rear axle carrier, 1st stage	MODEL 209	*BA35.20-P-1001-04A
3.5.07	Self-locking nut, tie rod to wheel carrier, silver or blue M10x1,5		*BA35.20-P-1002-04A

Icons	Remove/install		
⚠	Danger!	Risk of death caused by vehicle slipping or toppling off the lifting platform.	Align vehicle between columns of vehicle lift and position four support plates at vehicle lift support points specified by vehicle manufacturer.
ⓘ	Notes on self-locking nuts and bolts		AS00.00-Z-0010-01A
i	Installation	Only tighten nuts and bolts of chassis components when vehicle is in a ready-to-drive condition.	AH00.00-N-0001-01A
1	Lift vehicle on lifting platform.		AR00.60-P-1000P
2	Remove link rod (6k)	Nm Nm	AR32.30-P-0630-01P *BA32.20-P-1001-04C *BA32.20-P-1005-04C
3	Detach tie rod (4) from wheel carrier	⚠ Do not damage rubber sleeve when removing. Nm ⚡ ⚡	*BA35.20-P-1002-04A *210589046300 *201589013300
4	Mark installation position of eccentric disk relative to rear axle carrier (arrow)		
5	Remove bolt (4a) and remove tie rod (4)	Nm	*BA35.20-P-1001-04A
◀	Checking		
6	Check rubber mount (4b) for damage and replace rubber mount (4b) if necessary	⚡	AR35.20-P-0112-01P *203589014300

7	Install in the reverse order	
8	Perform a wheel alignment check	AR40.20-P-0200P

Nm Tie rod

Number	Designation			Model 203	Model 209	
BA35.20-P-1001-04A	Self-locking nut, track rod to rear axle carrier	Stage 1	Nm	70	70	
		Stage 2	∠°	-	-	
BA35.20-P-1002-04A	Self-locking nut, tie rod at wheel carrier	yellow M10 ×1	Nm	-	-	
		silver or blue M10 ×1	Nm	-	-	
		silver or blue M10 ×1.5	Stage 1	Nm	20	20
		Stage 2	∠°	45	45	

Nm Rear axle stabilizer bar

Number	Designation		Model 203	Model 209
BA32.20-P-1001-04C	Nut, link rod to stabilizer bar	Nm	40	40
BA32.20-P-1005-04C	Bolt, link rod to wheel carrier	Nm	40	50

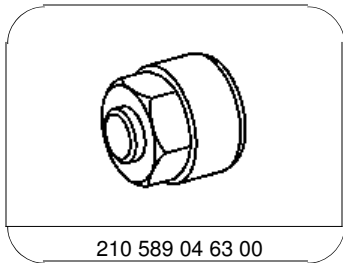

210 589 04 63 00

Thrust washer M 10x1.5



201 589 01 33 00

Puller

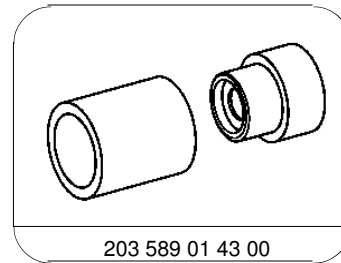

203 589 01 43 00

Extraction and insertion tool